

# T817/T818

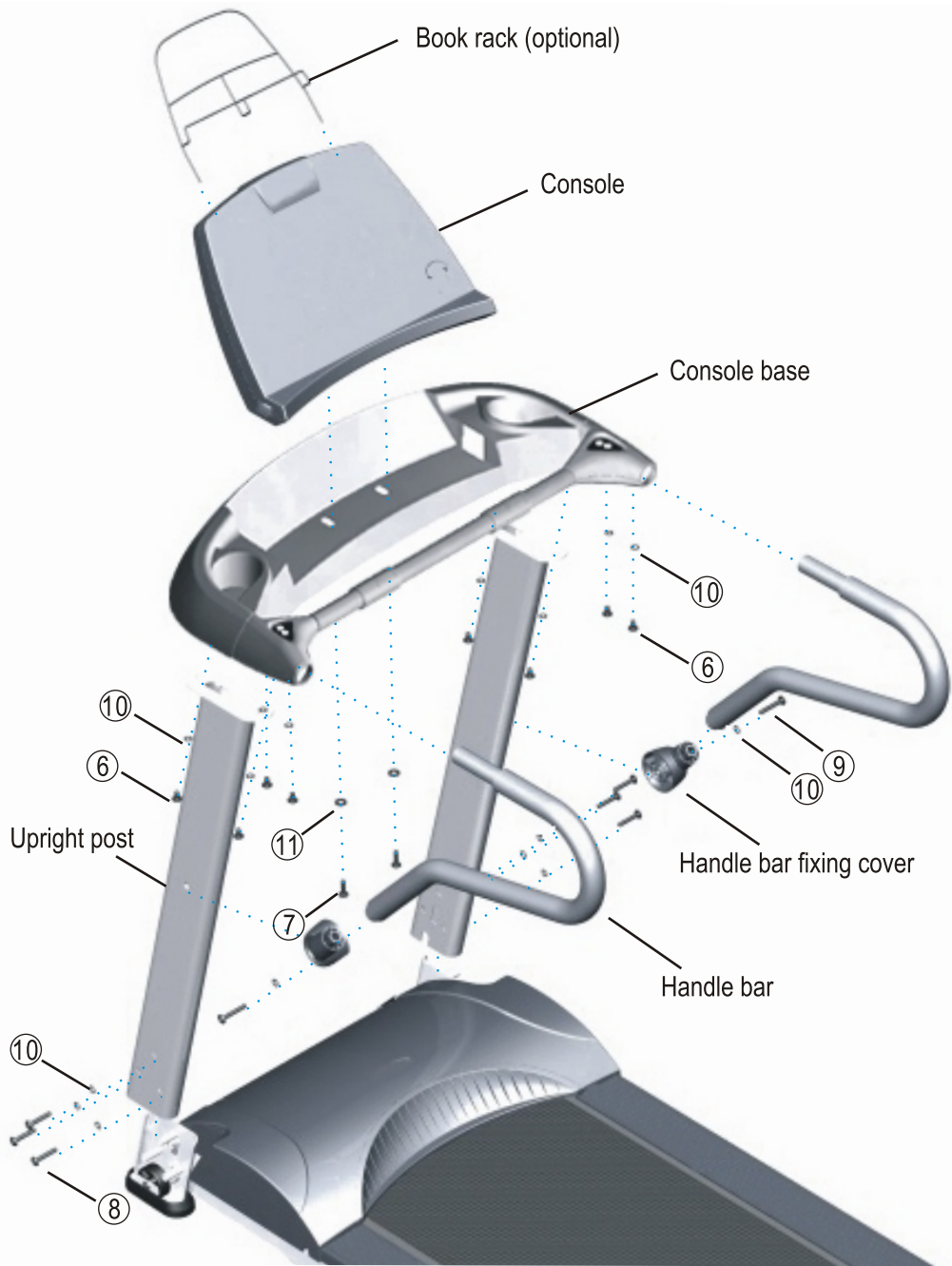

# T816

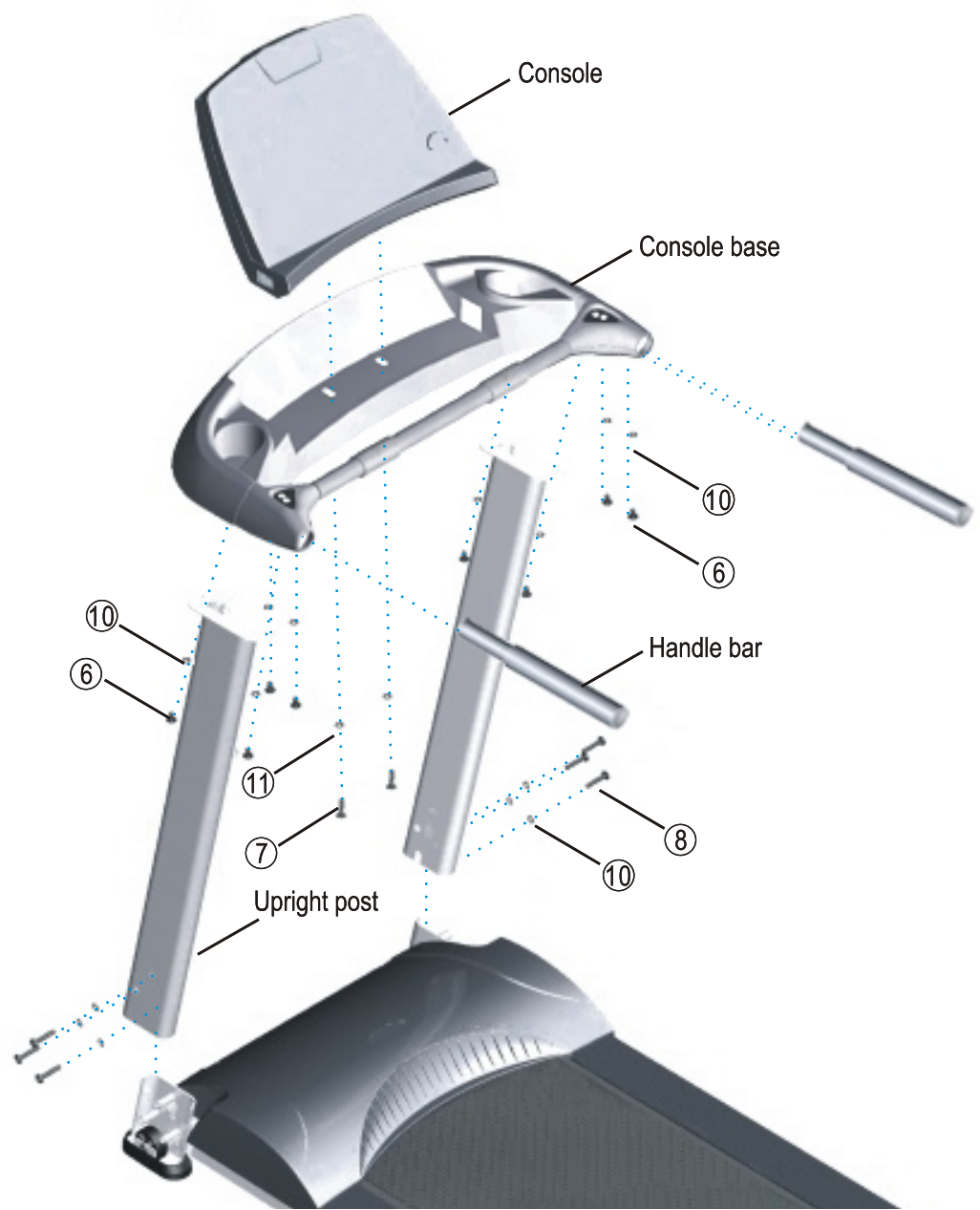

No.	Part description	Graph	Quantity		
			T816	T817	T818
1	Console		1	1	1
2	Console base		1	1	1
3	Upright post (R+L)		2	2	2
4	Handle bar (R+L)		2	0	0
5	Handle bar (R+L)		0	2	2
6	Screw, dome head M8x15mm		8	8	8
7	Screw, dome head M8x30mm		2	2	2
8	Screw, dome head M8x50mm		6	6	6
9	Screw, dome head M8x55mm		0	2	2
10	Washer, star M8x0.8mm		14	16	16
11	Washer, flat M10x2mm		2	2	2
12	Book rack (optional)		0	1	1
13	Cable, main frame, 1920mm		1	1	1
14	Cable, upright post, 1230mm		1	1	1
15	Cable, console, 440mm		1	1	1
16	Cable, ext. key, PCB, 270mm		0	2	2
17	Cable, ext. key, 200mm		0	1	2
18	Cable, ext. key, 380mm		0	1	0
19	Cable, signal, handle pulse PCB, 390mm		1	1	1
20	Cable, sensor, 1150mm		1	1	1
21	Allen key wrench, 6x50x90mm		1	1	1
22	Handle bar fixing cover		0	2	2



**Foldable treadmill  
Assembly instruction**

### STEP 1 Assemble upright post

1. Connect upright cable ⑭ to main frame cable ⑬.\*
2. Position the left upright post with care and make sure cables are not pinched.
3. Secure each upright post with three star washers ⑩ and three screws ⑧, M8x50mm.
4. DO NOT tighten any screw on upright post until you finish STEP 2.

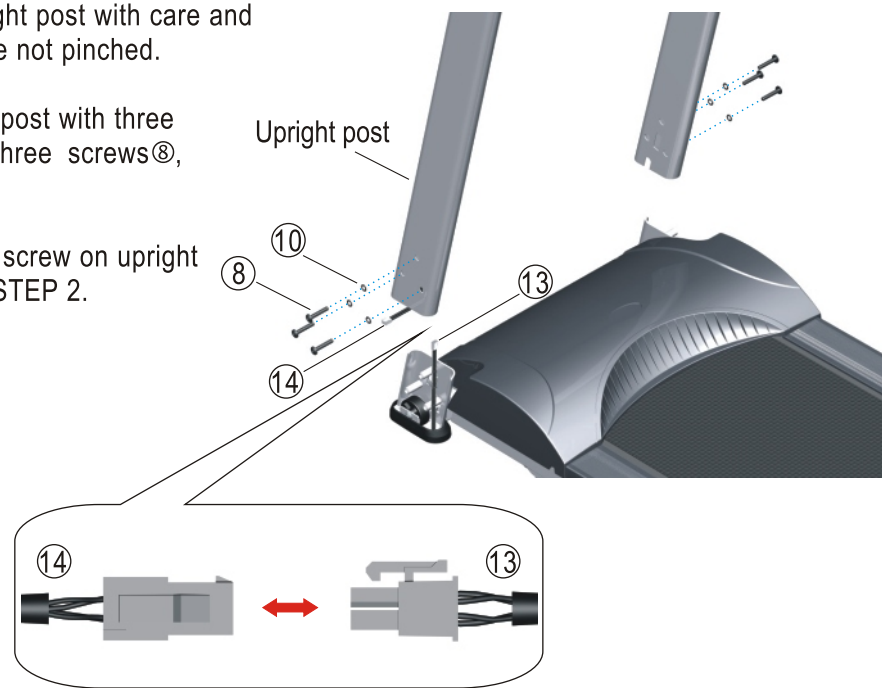

### STEP 3 Assemble console

1. Insert console cable/cables ⑮ ⑲ through the holes on the console base before setting console on the console base.
2. Secure and tighten console in place with two screws ⑦, M8x30mm and two flat washers ⑪.
3. Connect console cable ⑮ to upright cable ⑭ from the bottom.\*
4. Also, connect contact HR cables ⑲ to ⑳ together from the bottom.
5. T817, T818 only—connect extension key cables ⑰ to ⑱ and ⑱ to ⑱ together on both sides of the console from the bottom.

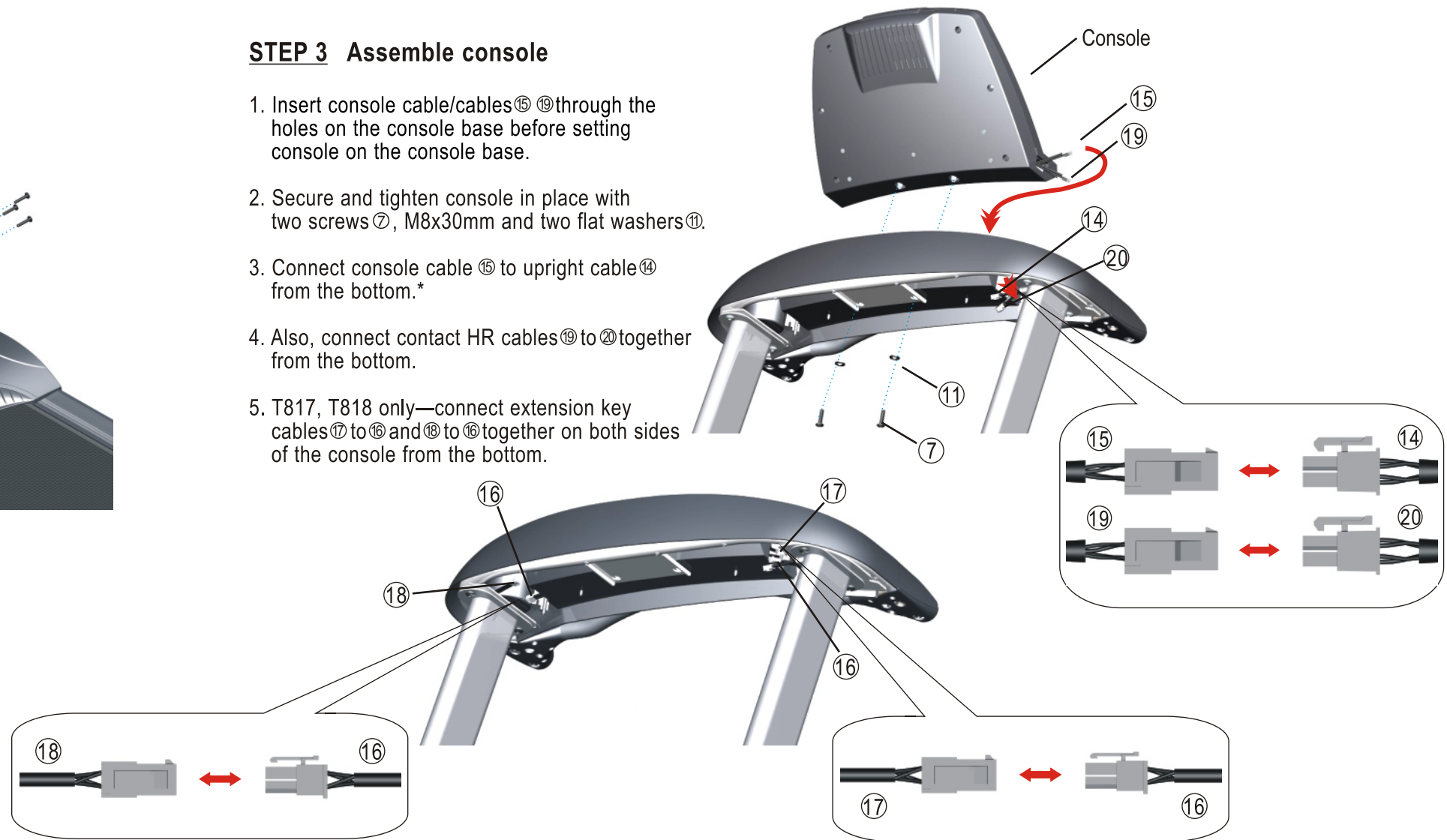

### STEP 2 Assemble console base

1. Position console base on upright posts and be careful not to damage cables.
2. Secure each upright post with two screws, M8x15mm ⑥ and two star washers ⑩.
3. Tighten console base screws.
4. Tighten the three screws, M8x50 on the bottom of each upright post. (Refer to STEP 1)

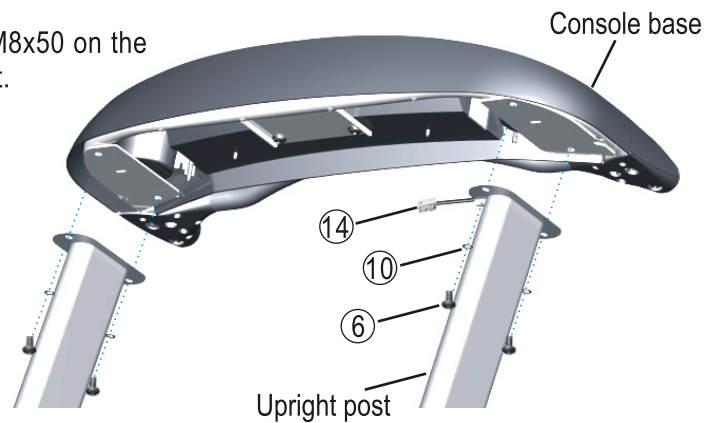

### STEP 4 Assemble handle bar

1. Insert handle bars into the console base.
2. Secure each handle bar to the console base with two screws ⑥, M8x15 and two star washers ⑩.
3. DO NOT tighten any screw until all screws on handle bar are in position.
4. T817, T818 only—insert fixing cover onto bottom of handle bar and secure them to the upright post with one screw ⑨, M8x55 and one star washer ⑩.
5. Tighten all screws after they are in position.



\*All cable connector alignment must be correct and secured tightly. Refer to detailed drawing. Be careful not to pinch or damage cables during assembly process.